

Inventory Data cover sheet (1 sheet per plot)

Project ID	Parcel ID	Original GPS coordinate of ①: 309410 1547603
GFI - OM <i>Pact</i>	ANBR3	

Measurement time and date: 8:45am ✓ 7 Mar 2012

Name of field crew leader: Khiev Samnang

File ID of picture from ① North: 102 - 0442

File ID of picture from ① East: 102 - 0443

File ID of picture from ① South: 102 - 0444

File ID of picture from ① West: 102 - 0445

File ID of picture from ① Up: 102 - 0446

Slope and aspect from point ①: _____

Was the original position of point ① changed? Yes No Remeasurement

If yes, why? _____

GPS coordinates (in UTM48N with Indian1960 datum)

3 readings of point ① GPS coordinates:

GPS ID 199 X 309410 Y 1547609 Photo ID: 102-0441

200 X 309406 Y 1547600

01 X 309405 Y 1547599

Note * ជម្រកសត្វព្រៃ តាម ៥ ចុះ លើ ផ្លូវ ដី ក្នុង តំបន់ ព្រៃ ឈូក លើ ដី ក្រសួង

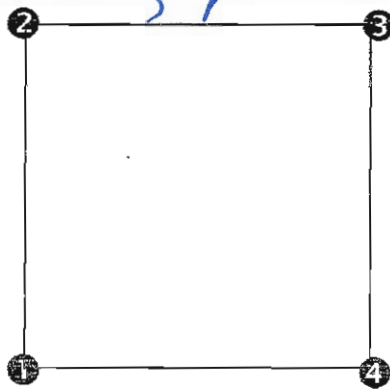

Data Review
(To be filled out after field crew returns from field)

Sheet checked by:
YEANG JONAL

Data entered by:
Suor Kimseng

Note = issue CF ✓

* Army Road:
X = 310779
Y = 1545922 ✓

* camp of Army
X = 0310795
Y = 1547999 ✓

- ឈ្មោះ:
- ① លោក គុំ ឌី ឌី (លីមីត) 26 ✓
Tel: 088 7401 121
 - ② លោក គុំ ឌី (លីមីត) ✓
Tel: 097 83 93 585
 - ③ លោក គុំ ឌី លី (លីមីត) ✓
Tel: 097 78 87 744
- check ✓

10
11
12
13
14
15
16
17
18
19
20
21
22
23
24
25
26
27
28
29
30
31
32
33
34
35
36
37
38
39
40
41
42
43
44
45
46
47
48
49
50
51
52
53
54
55
56
57
58
59
60
61
62
63
64
65
66
67
68
69
70
71
72
73
74
75
76
77
78
79
80
81
82
83
84
85
86
87
88
89
90
91
92
93
94
95
96
97
98
99
100



Handwritten text on a strip of paper, possibly a label or note, located near the bottom center of the page. The text is illegible due to blurring and low resolution.

Sketch of the plot (1 sheet per plot)

Project ID	Parcel ID
CFI - OM	ANBR 3

Name of drawer: Amanda

Name of field crew leader: Samnang

Please include significant features, both inside and outside of the plot.

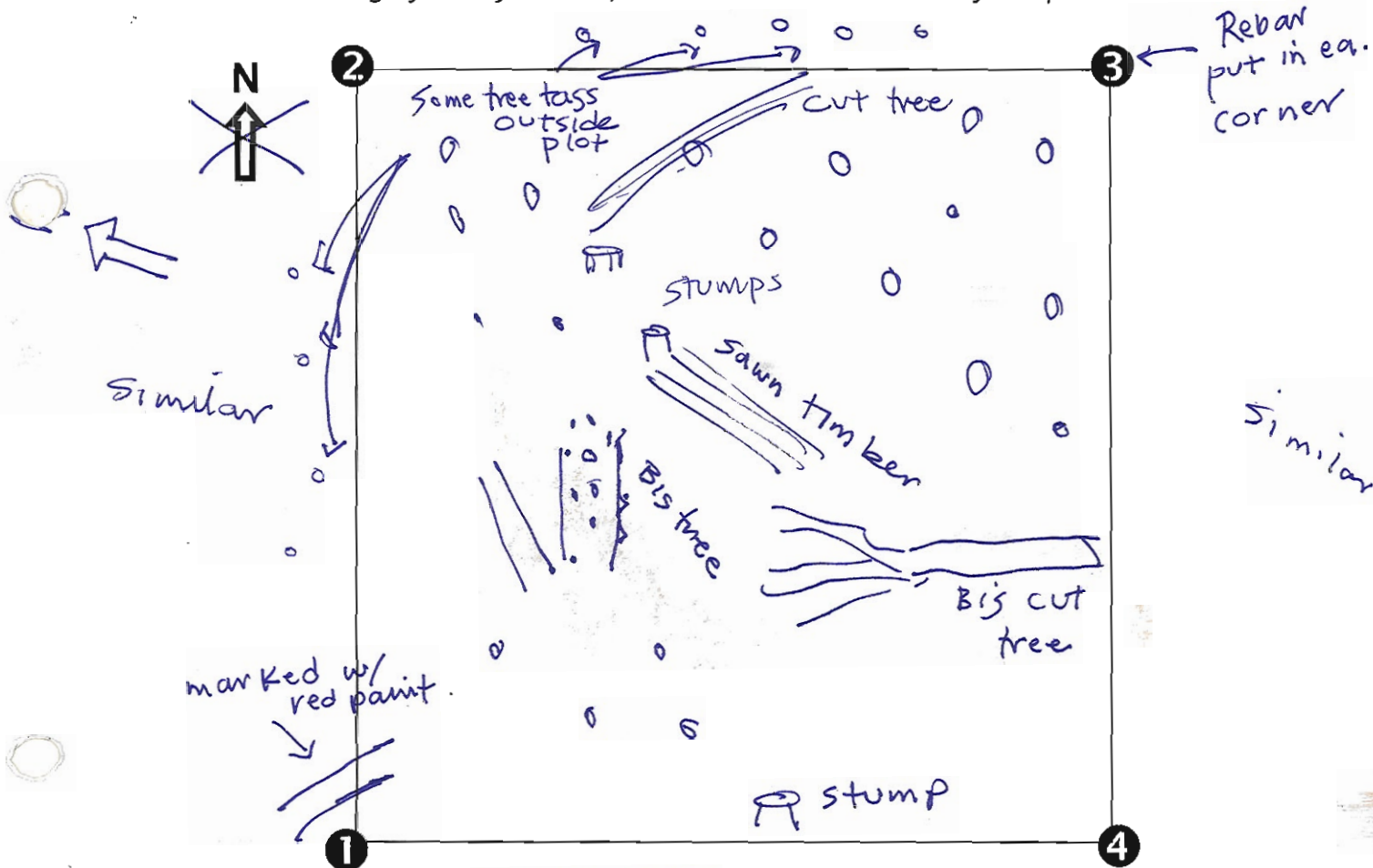

Description of forest status of the plot: sway road from Ktoy Chung Village to Thma Pook

Deciduous forest plot with recent ground fire (Feb?). Evidence of cutting - sawn timber + stumps - also looks recent, in Feb according to villagers. Mostly smaller trees, scattered, quite open canopy. Plot was not N-S orientation. We tried to follow original orientation but some trees outside.

Live tree datasheet (5 sheets per plot)

Project ID	Parcel ID
CFI - OM	ANBR 3

1

There are no live trees greater than 15.7 cm in circumference in this plot

Tag ID	Species	Circumference at Breast Height (cm)
00828	វៀង	30.0
00850	កំពង់ចាម (Kamphloeng)	25.0
030	កំពង់ចាម	50.3
346	ឆ្មារ	41.3
00817	ឆ្មារ	45.4
347	ឆ្មារ	49.0
343	ឆ្មារ	74.1
341	-	52.5
340	-	27.5
00866	-	66.8
02919	ឆ្មារ	65.2
02988	កំពង់ចាម	26.4
308/00089	ឆ្មារ	51.8
00852	កំពង់ចាម	27.5
00845	ឆ្មារ	65.5
60302	កំពង់ចាម	43.9
00819	-	21.0
01768	ឆ្មារ	20.6
30 01793 305	ឆ្មារ	143.0
304	ឆ្មារ	75.5

រដូវវស្សា

រដូវវស្សា

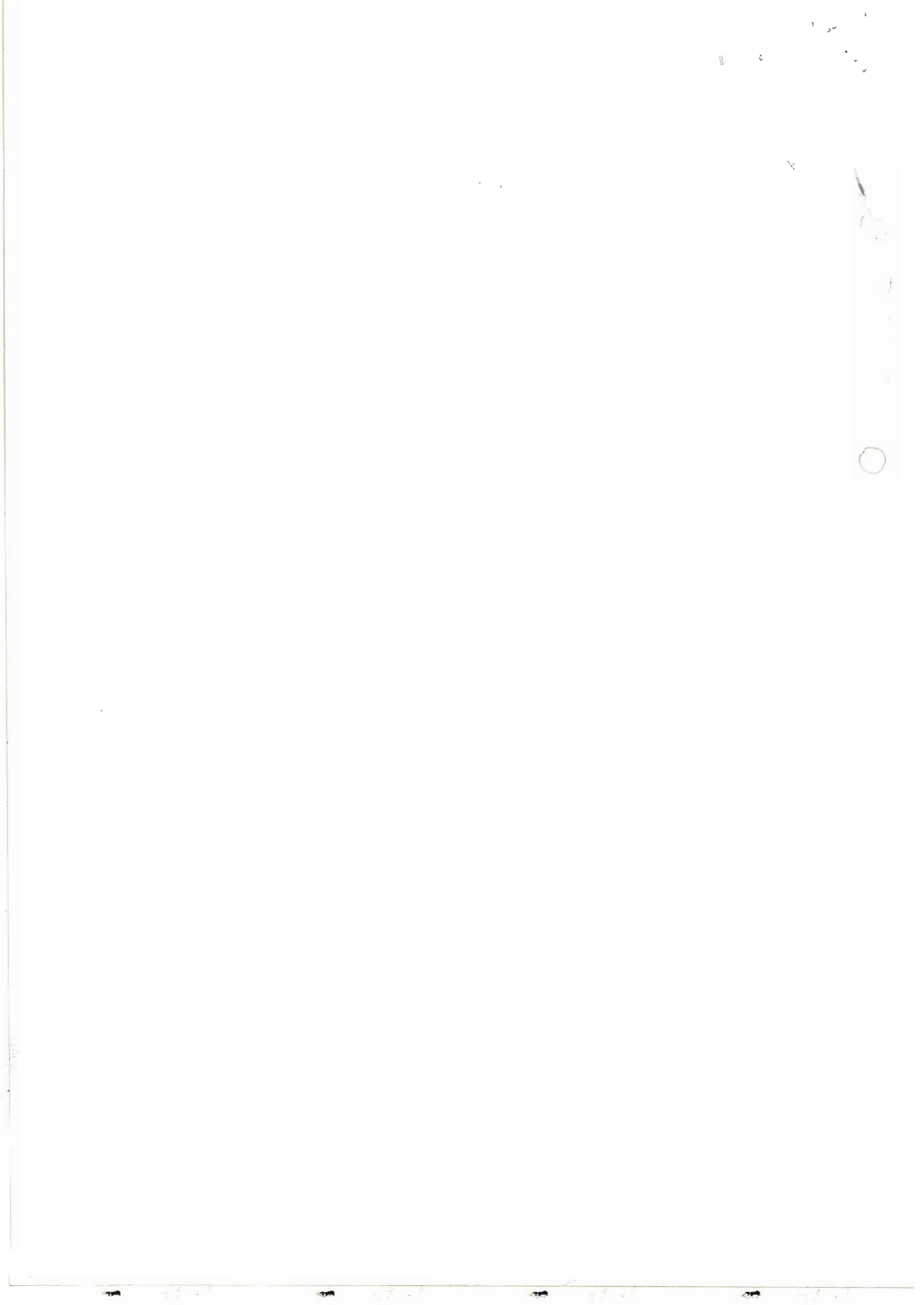

3- Live tree datasheet (5 sheets per plot)

Project ID	Parcel ID
CFI - OM	ANBR 3

There are no live trees greater than 175cm in circumference in this plot

Tag ID	Species	Circumference at Breast Height (cm)
320 / 01753	၅၅၅၀	29.9
01735	၅၅၅၀	17.6
3160083	-1-	28.5
00836	-1-	17
313	-1-	18.0
017166	၅၅၅၀ (Rums chek phonaw)	1.2
01736	၅၅၅၀	16.3
332	၅၅၅၀	38.5
330	၅၅၅၀	83.3
01706	၅၅၅၀	28.0
01712	၅၅၅၀	110.3
325	၅၅၅၀ (Reang sa)	26.5
326	၅၅၅၀	33.0
00857	-1-	66.5
327 00888	၅၅၅၀	91.3
328	၅၅၅၀	22.9
00883	၅၅၅၀	23.8
330	-1-	34.3
01763	-1-	16.2

01721	វិទ្យុ	30.4
380 01742	វិទ្យុ	37.2
01758	វិទ្យុ	16.0
00841	—	18.0
383	ក្រុងស្រីរាជ (Nieng Pha-ae)	24.3
384	វិទ្យុ	38 45.2
377	វិទ្យុ	38.4
01787	វិទ្យុ	19.9
378	—	38 28.2
370	វិទ្យុ	41
01739	—	22.0
331	—	70.0
01799	—	44.5
01773	វិទ្យុ	85.3
01774	វិទ្យុ	50.8
01729	វិទ្យុ	22.5
01755	ក្រុងស្រីរាជ	01755
366	វិទ្យុ	64.1
01770	វិទ្យុ	98.5
367	វិទ្យុ	147.5
371	វិទ្យុ	74.2
372	វិទ្យុ	64.1
375	វិទ្យុ	43.2
374	—	37.5

2

Live tree datasheet (5 sheets per plot)

Project ID	Parcel ID
CFI - OM	ANBR3

There are no live trees greater than 15.7 cm in circumference in this plot

Tag ID	Species	Circumference at Breast Height (cm)
02993	ឃ្លាតក្រហម	18.4
02935	ឃ្លាត	24.4
02996	—	30.8
02903	ស្រូវសំបក	17.4
310	ឃ្លាត	50.4
02975	ឃ្លាត	80.0 87.3
02986	ឃ្លាត	171
02984	ឃ្លាត	84.9
02999	ឃ្លាត	72.7
02930	ស្រូវសំបក	20.4
02910	ឃ្លាត	119.0
315	ឃ្លាត	44.5
02937	ឃ្លាត	44.3
02917	ឃ្លាត	29.0
00861	ឃ្លាត	16.7
00817	—	17
01786	—	33
00894	ឃ្លាត	48
01703	—	85.7
319	—	39.9



373	ଅନୁସନ୍ଧାନ	50.3
00896	ଅନୁସନ୍ଧାନ	18.2
395	ଅନୁସନ୍ଧାନ	78.0
00744	ଅନୁସନ୍ଧାନ	58.1
396	ଅନୁସନ୍ଧାନ	59.0
01723	ଅନୁସନ୍ଧାନ	22.1
3130	- 1 -	33.2
394	- 1 -	62.5
00851	ଅନୁସନ୍ଧାନ	17.4
3131 3131	ଅନୁସନ୍ଧାନ	38.7 19.8
3132	ଅନୁସନ୍ଧାନ	66.1
01749	- 1 -	21.5
01744	ଅନୁସନ୍ଧାନ	27.6
01778	ଅନୁସନ୍ଧାନ	27.0
398 398	ଅନୁସନ୍ଧାନ	101.3
399	ଅନୁସନ୍ଧାନ	40.5
3139	- 1 -	68.5 68.4
3137	ଅନୁସନ୍ଧାନ	68.4 30
3138	ଅନୁସନ୍ଧାନ	93.2
353	ଅନୁସନ୍ଧାନ	42.4
01769	ଅନୁସନ୍ଧାନ	21.5
01740	- 1 -	18.2
01794	- 1 -	16.5
354	- 1 -	42.2

Canopy percentage datasheet (1 sheet per plot)

Project ID	Parcel ID
CFI - OM	ANBR 3

Grid Cell	Number of Sky squares	Number of Canopy squares
1	14	10
2	7	17
3	9	15
4	11	8
5	10	14
6	7	17
7	5	19
8	2	22
9	1	23
10	8	16
11	20	4
12	0	24
13	22	2
14	11	13
15	20	4
16	21	3

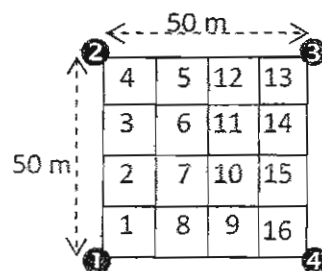

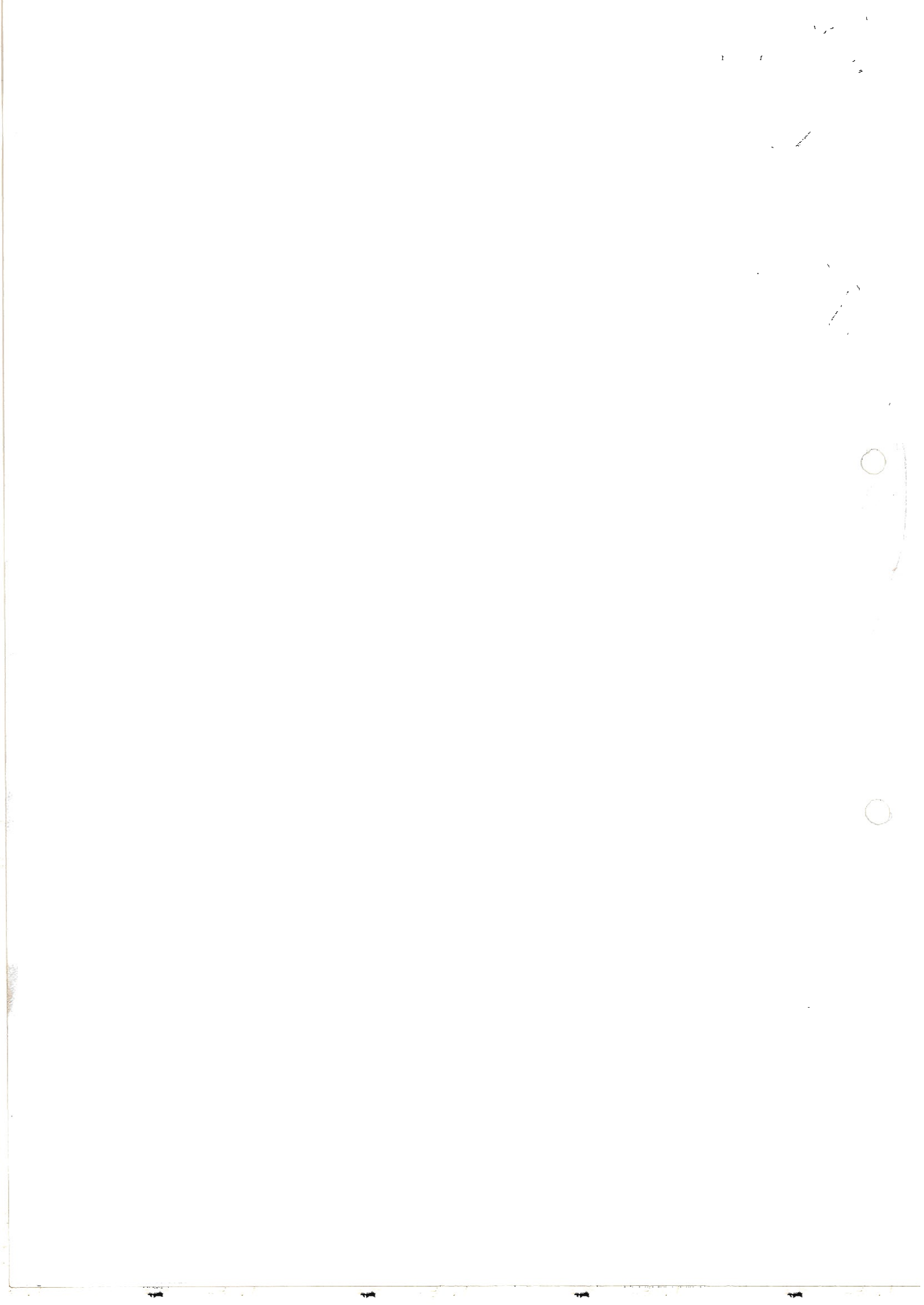

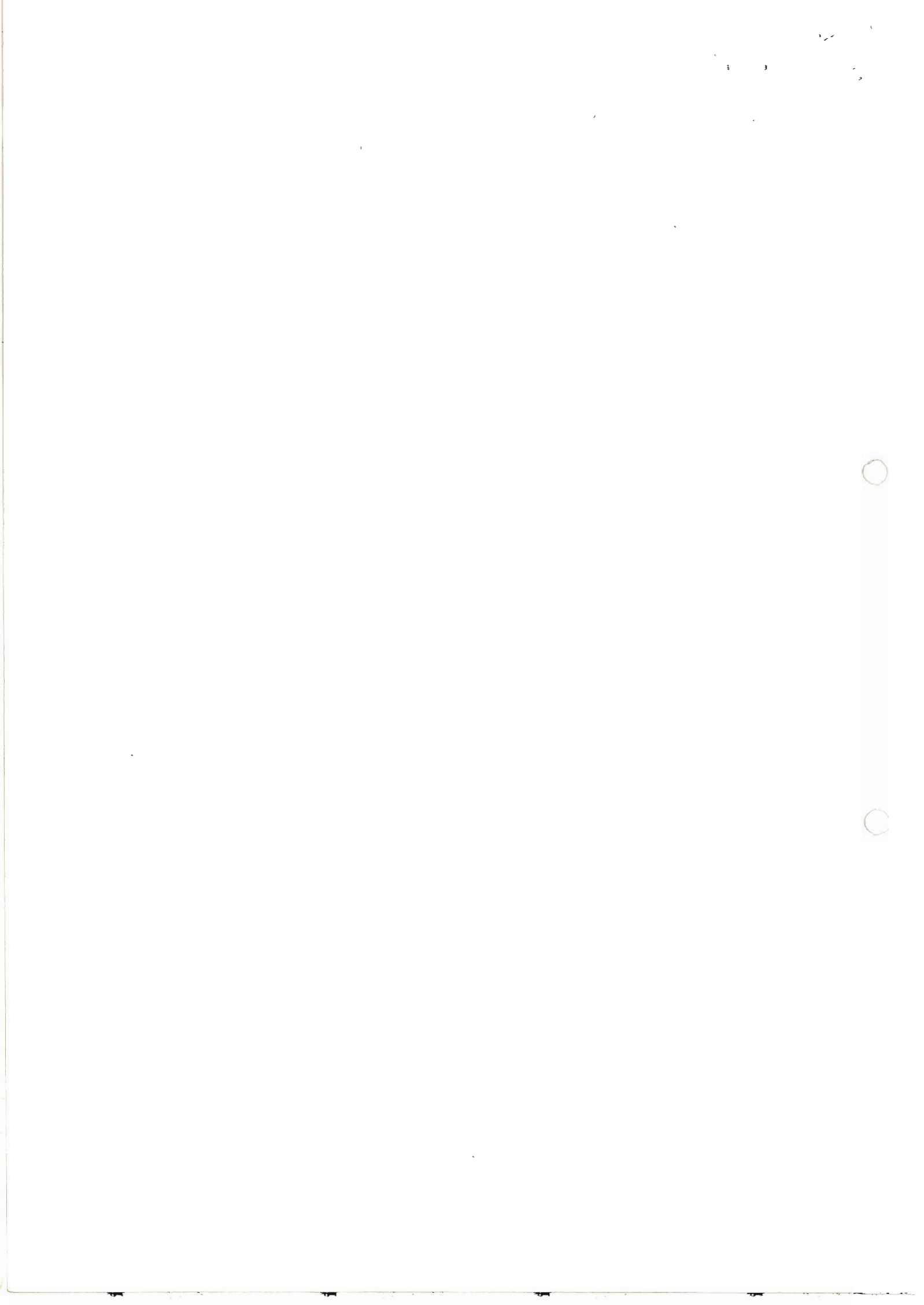



Resources for plot re-location (1 sheet per plot)

This ground information datasheet will be used by field crew members to re-locate plots in the future, as well update data on electronic maps. Field crew members will record the names of nearby ponds, streams, etc to a plot. Future field crew members can then use these names as geographic point of reference when searching for the same plots.

Significant feature to plot location	Geography	Local name of the area	Coordinate X	Coordinate Y	Description of Area
<i>From Kondul village to RLTH120</i>	<i>Pond</i>	<i>Tasoam</i>	<i>1450406</i>	<i>347839</i>	<i>There is water in dry season and a big tree has fallen in the pond. You can usually see wild pigs' foot prints.</i>

